

Water-Resistant Housing

INSTALLATION INSTRUCTIONS

Notes:

- Prior to install, confirm transmitter is functioning and configured to correct settings.
- It is recommended that a gage be installed first to help with locating the housings on the shaft.
- If a gage is already installed, terminate the wires at a terminal strip.
- Housings are shipped with gage and power cables. To ensure water resistance, **no other cabling should be used.**
- Install transmitter with the label side facing away from the shaft. Failure to do so may result in loss of signal transmission.

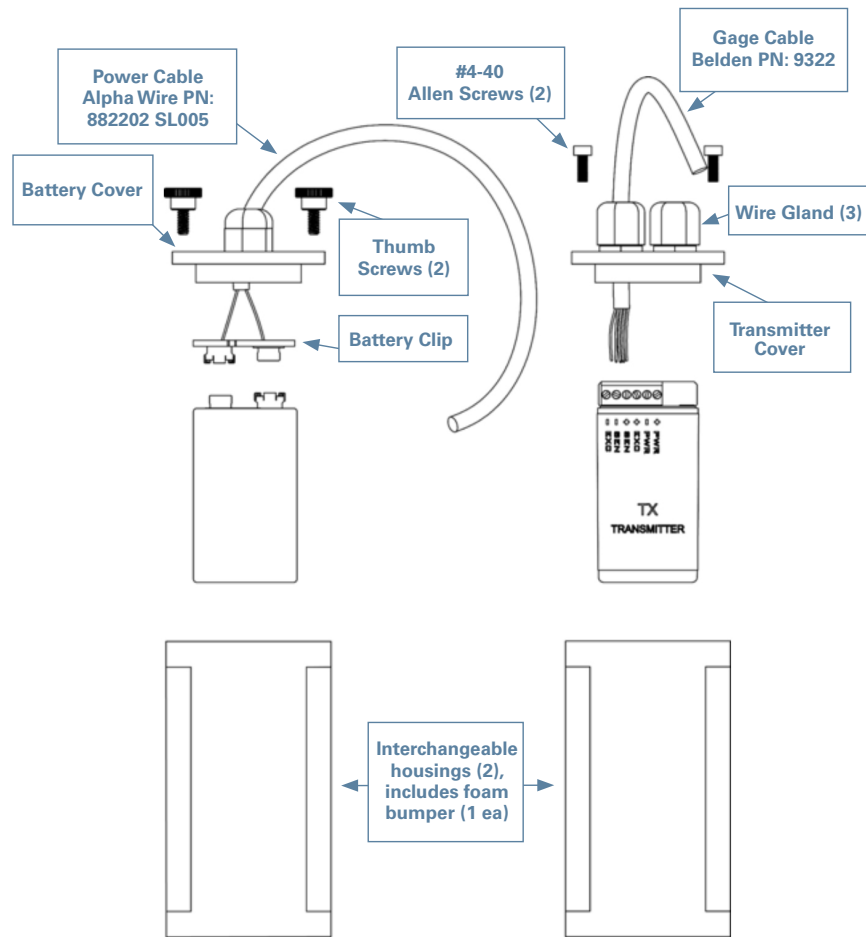

STEPS

- 1 Position a housing on the shaft, near the strain gage (for the transmitter) and the other housing 180° away (for the battery). If necessary, use butyl rubber supplied with the TorqueTrak measurement system to hold the housings in place until taped.
- 2 Secure housings to the shaft using fiberglass reinforced strapping tape. The tape should be wrapped around at least 10 times (5 times in each direction) to secure the components to the shaft. The open end of the tape should follow shaft rotation. For extra protection, glue the end of the tape down.
- 3 Determine the length of power cable needed to reach between the housings and add approximately two inches to this total.
- 4 Cut power cable to above determined length and slide through the open wire gland on the transmitter housing cover.
- 5 Strip and tin wire ends.
- 6 Connect gage wires and battery wires to the transmitter.
- 7 Secure the transmitter cover to the housing with the two supplied screws. Make certain the screws are tight to provide a good gasket seal.
- 8 Push the wires into the housing until the transmitter is at the bottom of housing. Resistance will be felt once it has bottomed out.
- 9 Tighten the wire glands to the point where the rubber washers are protruding above the gland and around the wire (see image below). Don't overtighten.
- 10 Cut the gage wires to length, strip the ends and terminate at the gage or terminal strip.
- 11 Connect battery to battery clip and repeat steps 7-9 for the battery housing cover.
- 12 If necessary, secure excess wires to shaft with sufficient fiberglass reinforced tape.

